

V3764 WS3 DLFC NPT ASY or V3764BSPT WS3 DLFC BSPT ASY

Drawing No.	Order No.	Description	Quantity
1	V3190-090	WS1 DLFC 9.0 gpm for 1	Install One or More DLFC washers. DLFC washers must be purchased separately. When using one retainer and one o-ring up to 5 DLFC washers can be used for flow rates from 9 gpm up to 125 gpm. When using two retainers and two o-rings, 5 DLFC washers are used in one of the retainers and up to 4 more DLFC washers can be used in the other retainer for flow rates from 9 gpm up to 225 gpm.
	V3190-100	WS1 DLFC 10.0 gpm for 1	
	V3190-110	WS1 DLFC 11.0 gpm for 1	
	V3190-130	WS1 DLFC 13.0 gpm for 1	
	V3190-150	WS1 DLFC 15.0 gpm for 1	
	V3190-170	WS1 DLFC 17.0 gpm for 1	
	V3190-200	WS1 DLFC 20.0 gpm for 1	
	V3190-250	WS1 DLFC 25.0 gpm for 1	
2	V3765-01	WS3 DLFC HOUSING NPT	1
	V3765BSPT-01	WS3 DLFC HOUSING BSPT	
3	V3766	WS3 DLFC RETAINER	1 or 2
4	V3767	WS3 DLFC RETAINER COVER	1
5	V3768	WS3 DLFC RETAINER RING	1
6	V3769	O-RING 336	1 or 2

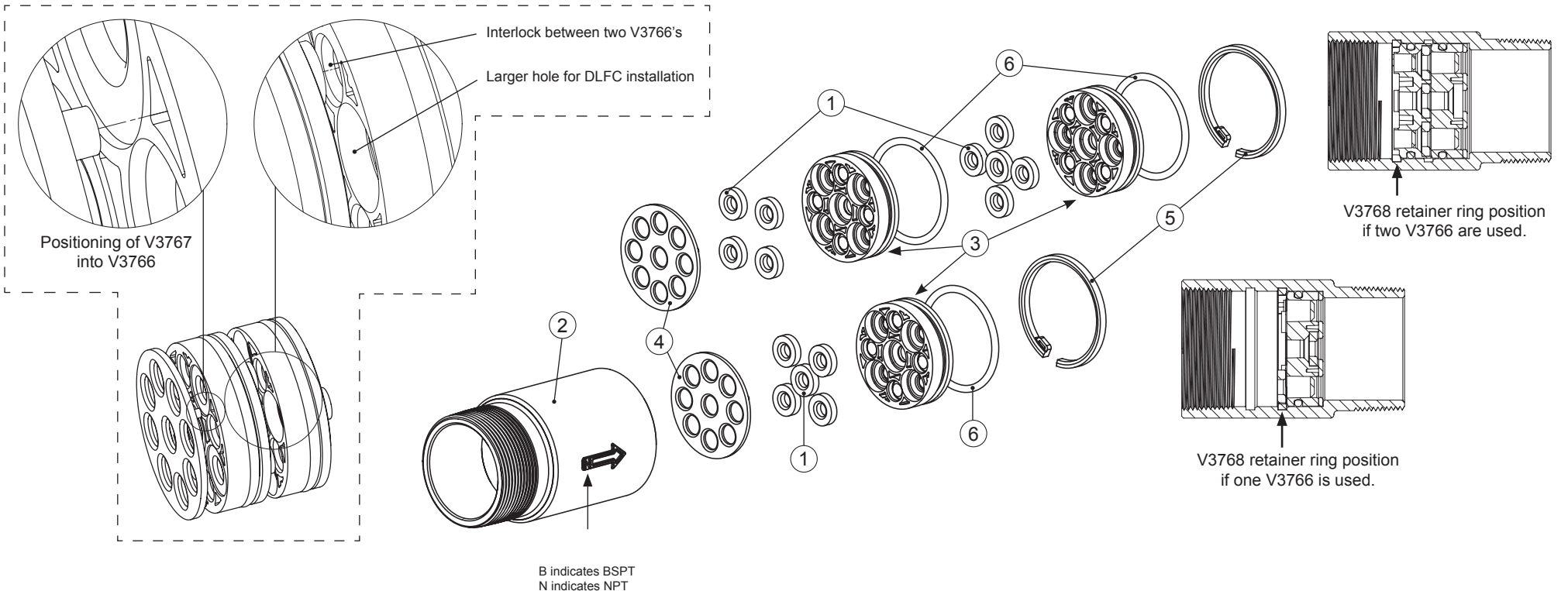

V3764 WS3 DLFC NPT ASY or V3764BSPT WS3 DLFC BSPT ASY

HYDROCARBONS SUCH AS VASELINE®, PETROLEUM JELLY, KEROSENE, BENZENE, GASOLINE, ETC., WILL DAMAGE PRODUCTS THAT CONTAIN O-RINGS OR PLASTIC COMPONENTS. EXPOSURE TO SUCH HYDROCARBONS MAY CAUSE THE PRODUCTS TO LEAK. DO NOT USE CLACK CONTROL VALVE PRODUCT(S) ON WATER SUPPLIES THAT CONTAIN HYDROCARBONS SUCH AS KEROSENE, BENZENE, GASOLINE, ETC.

Assemblies are shipped without drain line flow control (DLFC) washers.

Assembly instructions:

1. Determine the desired flow rate. Select a combination of V3190-XXX's to arrive at the desired flow rate.
2. Using a drill or punch remove the desired knockout(s) in V3766. Each V3766 retainer contains two types of knock outs. The larger knockouts are removed to install a DLFC. If two V3766 retainers are needed remove the smaller diameter knockout that lines up with the DLFC installed in the other retainer. One or two V3766 retainers may be used. When using one V3766 retainer V3190-XXX must be installed in the center hole. When using two V3766 retainers a V3190-XXX must be installed in the center hole of one of the retainers and the center hole on the other retainer must remain open.
3. After desired knockout(s) are removed make sure the new holes are smooth with no rough or jagged areas.
4. Install appropriate size(s) of drain line flow control washers. Pay close attention to proper DLFC orientation.
5. Each assembled V3766 retainer must have a V3769 o-ring installed. One of each of the V3767 retainer cover and V3768 retainer ring must be used whether one or two V3766 retainers are used. The positioning of the V3768 retainer ring varies depending on the number of V3766 retainer(s) used. Ensure that the V3768 retainer ring is fully inserted in a groove and that the V3768 retainer ring tab is not contacting the V3766 WS3 DLFC Retainer. Properly orientate the V3766(s) in the direction of flow.

Correct:

V3768 WS3 DLFC Retainer Ring seated into groove properly. V3768 WS3 DLFC Retainer Ring tab not in contact with raised portions of V3766 WS3 DLFC Retainer.

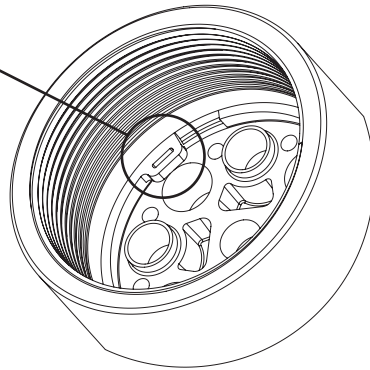

Incorrect:

V3768 WS3 DLFC Retainer Ring not seated into groove
V3768 WS3 DLFC Retainer Ring tab is being held up by V3766 WS3 DLFC Retainer preventing the V3768 WS3 DLFC Retainer Ring from locking into the groove

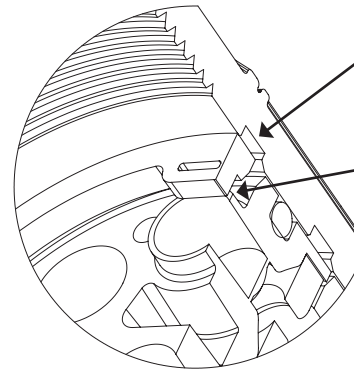

6. Properly orientate the complete assembly in the direction of flow. Inlet and outlet threads are 3".